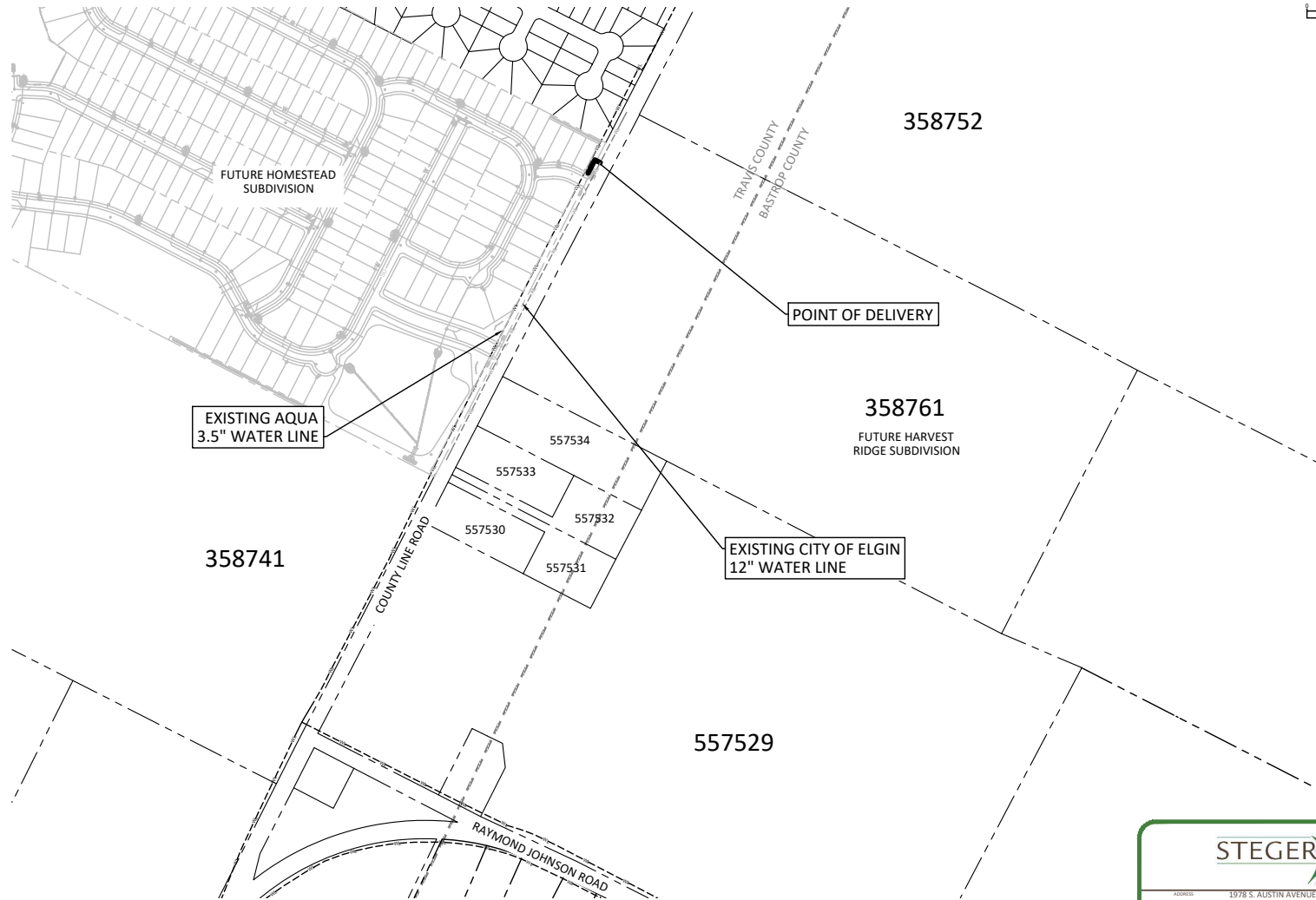

EXHIBIT B

DESCRIPTION OF POINT OF DELIVERY



STEGER BIZZELL

ADDRESS	1978 S. ALSTIN AVENUE	GEORGETOWN, TX 78626
PHONE	512.930.9412	TEXAS REGISTERED ENGINEERING FIRM F-181 TBPLS FIRM No. 10003700
WEBSITE	STEGERBIZZELL.COM	
SERVICES	>>ENGINEERS >>PLANNERS >>SURVEYORS	

DATE 02/12/2020 JOB NO. 19970.281

These drawings are the sole property of STEGER & BIZZELL ENGINEERING, INC. The use of these drawings is hereby restricted to the original site for which they were prepared. Reproduction or reuse of these drawings in whole or in part without written permission of STEGER & BIZZELL ENGINEERING, INC. is strictly prohibited.